

Classroom **projection** system

To turn on the projection system, **Press Anywhere to Start**.

A pop-up will appear notifying you that the projector is warming up.

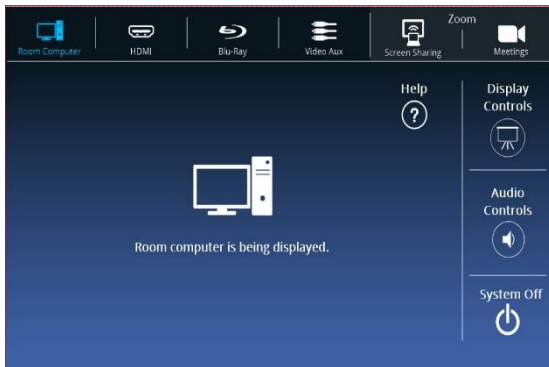
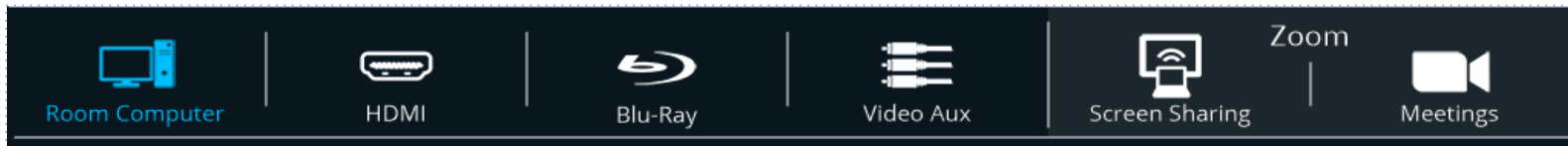

Select an input from the top menu. By default, the **Room Computer** input is selected.

Note: The room computer is capable of running either Mac or Windows.

If connecting a laptop to the projector, **plug** the HDMI cable into the laptop to turn on the system. The HDMI cable is labeled on the lectern for easy identification.

If playing a Blu-Ray or DVD, select **Blu-ray**.

Note: The Blu-Ray player can be found inside the podium's keyboard tray. You can control the Blu-Ray player from the touch panel.

This room is equipped with Zoom for wireless projection. To use, select **Zoom Screen Sharing** or **Zoom Meeting** from the top menu. See the Zoom instructions for details.

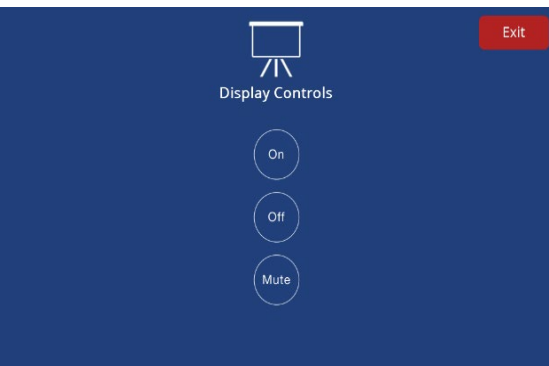

To temporarily turn off the projector display, under **Display Controls** tap **Mute**.

To turn the display back on, tap **Mute** again.

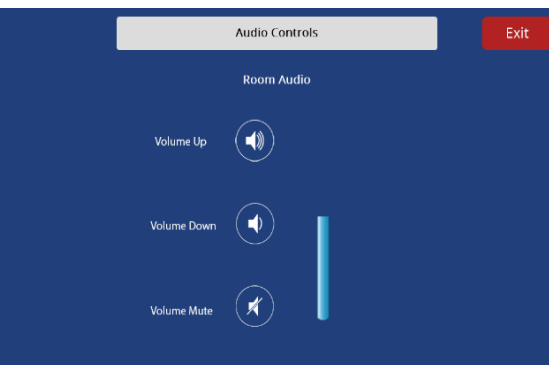

To adjust the volume, tap **Audio Controls**, and use the speaker buttons under **Room Audio**. You may also **Mute** the Room Audio.

Note: Only some rooms are equipped with microphones.

Tap **Exit** to return to the main screen.

To turn off the projection system, tap **System Off**. A pop-up will appear asking you to confirm shutdown. A pop-up then appears notifying you that the projector is cooling down.