

Giving Opportunities, continued

Blending High-Tech and History

Honoring the past while looking toward the future, the Alumnae House renovation will model sustainable design and construction, update technology and provide more practical office, meeting and event areas to connect our community. At the same time, it will restore the cherished spaces that make the Alumnae House special, including the Alumnae Library, the class lockers and its beautiful terraces.

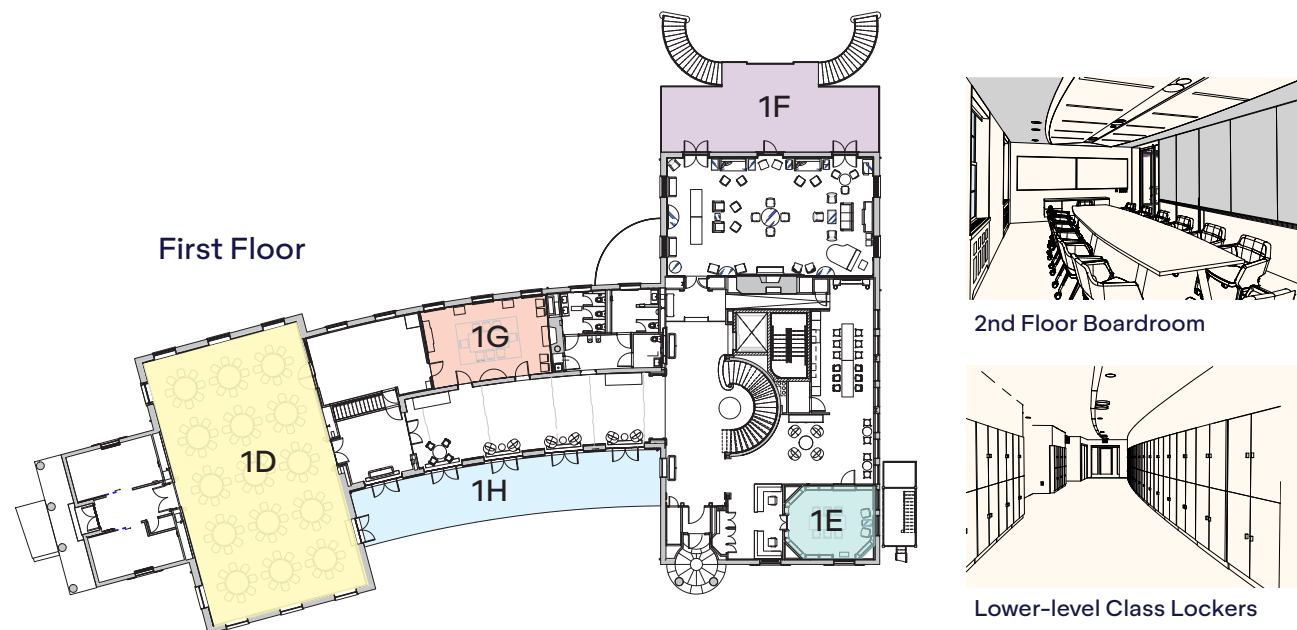

GIFT AMOUNT

- 1D Conference Hall** **\$1,000,000**

One of the best meeting rooms on campus, Conference Hall will be fully updated for year-round, accessible and more effective use with such upgrades as air conditioning, acoustic paneling, new lighting, remote-control window shades and state-of-the art technology, including a video wall and tower speakers.
- 1E Alumnae Library** **\$500,000**

One of the hidden gems on campus, the Alumnae Library, which houses a collection of class yearbooks as well as books written by alumnae authors from 1880 to today, will be refurbished, reorganized and relocated to the first floor near the new Welcome Center to increase its accessibility. The addition of a conference table and high-tech audiovisual equipment will give it renewed purpose as a contemporary meeting space.
- 1F Living Room Terrace** **\$500,000**

New exterior doors and reset bluestone pavers will enhance access to this stunning location for outdoor events. With remarkable views of the Pelham Hills and overlooking Trudy's Garden—named after a former executive director of the Alumnae Association—as well as Elliot Offner's famed *Bittern Mother and Child* sculpture, this is one of the prettiest spots on campus.
- 2nd Floor Boardroom** **\$500,000**

Relocated to the east wing of the building, the second-floor boardroom will accommodate 14 seats with high-tech audio, double video monitors, acoustic walls and built-in bulletin boards to encourage brainstorming.
- 1G Dining Room** **\$250,000**

This intimate gathering space will be restored—refinished floors and furniture, new drapery and more—and modernized with audiovisual technology so it can be fully utilized for meetings, presentations and workshops.
- 1H Elm Street Terrace** **\$250,000**

A new, larger terrace accessible through the French doors off the Art Gallery will provide a delightful new gathering space with views of College Hall and the Museum of Art and extend the first-floor common space during events. New landscaping and outdoor lighting will make the space usable day and night. See an image on the cover.
- Lower-level Class Lockers** **\$250,000**

Whimsically painted and filled with Reunion keepsakes and memorabilia for each class, Smith's class lockers are a very special touchpoint for Reunion volunteers and other Smithies returning to campus. In this renovation, the class locker corridor will be refurbished and updated with new ceilings, lighting, air conditioning and flooring. See images on page nine.

Your Support Will Help Write the Next Chapter

A Storied History



On both the National and State Registers of Historic Places as part of the Northampton Downtown Historic District, Alumnae House was constructed in 1937, largely through the generosity of alums, whose vision was for the building to be a center of both alumnae and college activity. Designed by Frederick J. Woodbridge, an Amherst College graduate with the firm Evans, Moore and Woodbridge, the building stylishly contrasted a Neoclassical and Georgian exterior with a modern Art Deco interior, which was popular at the time. Remarkably, the building has retained many of its original details, which this project will maintain.

Used primarily as offices for the Alumnae Association and development staff working on behalf of alumnae, as well as providing space for meetings and special Smith traditions

including Reunion gatherings, monthly faculty meetings, trustee coffees and student teas, the building has also served as a naval training school during World War II for the WAVES (Women Accepted for Volunteer Emergency Service). Today, the building houses the Office of Alumnae Relations and Development and will continue to offer spectacular meeting and welcome spaces to bring our alumnae and campus community together.



Crews broke ground on the Alumnae House on March 30, 1937. On June 19, the cornerstone was laid in a ceremony attended by President William Allan Neilson.

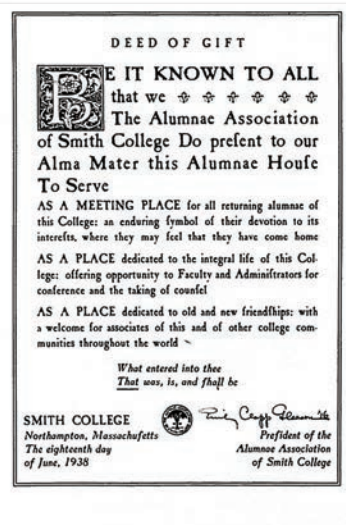

The deed presented by the Alumnae Association to the college at the dedication of the Alumnae House in 1938.



In the *Smith Alumnae Quarterly*, Elizabeth Cutter Morrow 1896 wrote of the new Alumnae House, "It had been an act of faith to plan for it and its completion seemed a miracle."



clockwise from left:
Florence H. Snow 1904, secretary of the Alumnae Association, serves tea to Smith's first group of WAVES in November 1942.



Many student organizations utilize the Alumnae House, including these students from the Black Students Organization in 2001.

Elliot Offner's bronze *Bittern Mother and Child* was permanently placed on view in the garden behind the Alumnae House in 2010.

Alumnae Association event, hosted in the Living Room in 1971.



Painted on corkboard on the curved back wall of the grand staircase in 1938, the first-floor mural was conceived and given by Elizabeth Cutter Morrow, class of 1896, to showcase alumnae around the United States. It also depicts airplanes in homage to Morrow's daughter, Anne Morrow Lindbergh '28, wife of the famed aviator. The mural will be restored and highlighted in the new Welcome Center.



A cozy spot for contemplation and reading, the original second-floor Alumnae Library, circa 1940, will be relocated off the first-floor Welcome Center for accessibility, but will retain all of its original charm.



In 1939, art studio students Helen Affhauser '39, Myrtle Affhauser '39 and Dorothy Holcomb '40 painted the basement-level lockers—designed to hold the Reunion supplies of each class—with class years and a delightful menagerie of animals.



SMITH COLLEGE

CONTACT

For more information and to give a gift:

Betsy Carpenter '93

Associate Vice President for Development

ewcarpen@smith.edu

(413) 585-2052

APRIL 2021